

For Sale | Industrial

217-14 Hempstead Ave, Queens Village, NY



Building Size: 3,400 sf ±
Lot Size: 0.06 acres ±
Offices: 50%
Lower Level Storage: 1,200 sf ±
Ceiling Height: 12' ±
Loading: 1 Drive-In
Heat: Oil
Power: TBD
Zoning: Commercial (R3-2)

Sale Price: \$ 1,600,000
Approx. Taxes: \$ 19,950.65 ±

- 20W Generator
- Completely renovated in 2019
- Located 5 minutes from new UBS Arena

METRO

REALTY SERVICES LLC

201 Moreland Road, Ste 4, Hauppauge, NY 11788

(631) 770-0700 ~ info@metrorealtyservices.com

www.metrorealtyservices.com

Exclusive Agent:

Mark Timpone
Licensed Real Estate Broker
Managing Partner
Cell: [\(516\) 375-8069](tel:5163758069)
mark@metrorealtyservices.com

Exclusive Agent:

Jeremy D. Hackett
Licensed Real Estate Broker
Managing Partner
Cell: [\(516\) 456-0108](tel:5164560108)
jeremy@metrorealtyservices.com

For Sale | Industrial

217-14 Hempstead Ave, Queens Village, NY



METRO

REALTY SERVICES LLC

201 Moreland Road, Ste 4, Hauppauge, NY 11788

(631) 770-0700 ~ info@metrorealtyservices.com

www.metrorealtyservices.com

Exclusive Agent:

Mark Timpone

Licensed Real Estate Broker

Managing Partner

Cell: [\(516\) 375-8069](tel:(516)375-8069)

mark@metrorealtyservices.com

Exclusive Agent:

Jeremy D. Hackett

Licensed Real Estate Broker

Managing Partner

Cell: [\(516\) 456-0108](tel:(516)456-0108)

jeremy@metrorealtyservices.com

All information submitted is subject to errors, omissions, change of price or rental, change of other terms and conditions, prior sale, lease, financing or withdrawal without notice. All areas and dimensions are approximate. This advertisement does not suggest that the broker has a listing on this property or properties or that any property is currently available.

217-14 HEMPSTEAD AVE

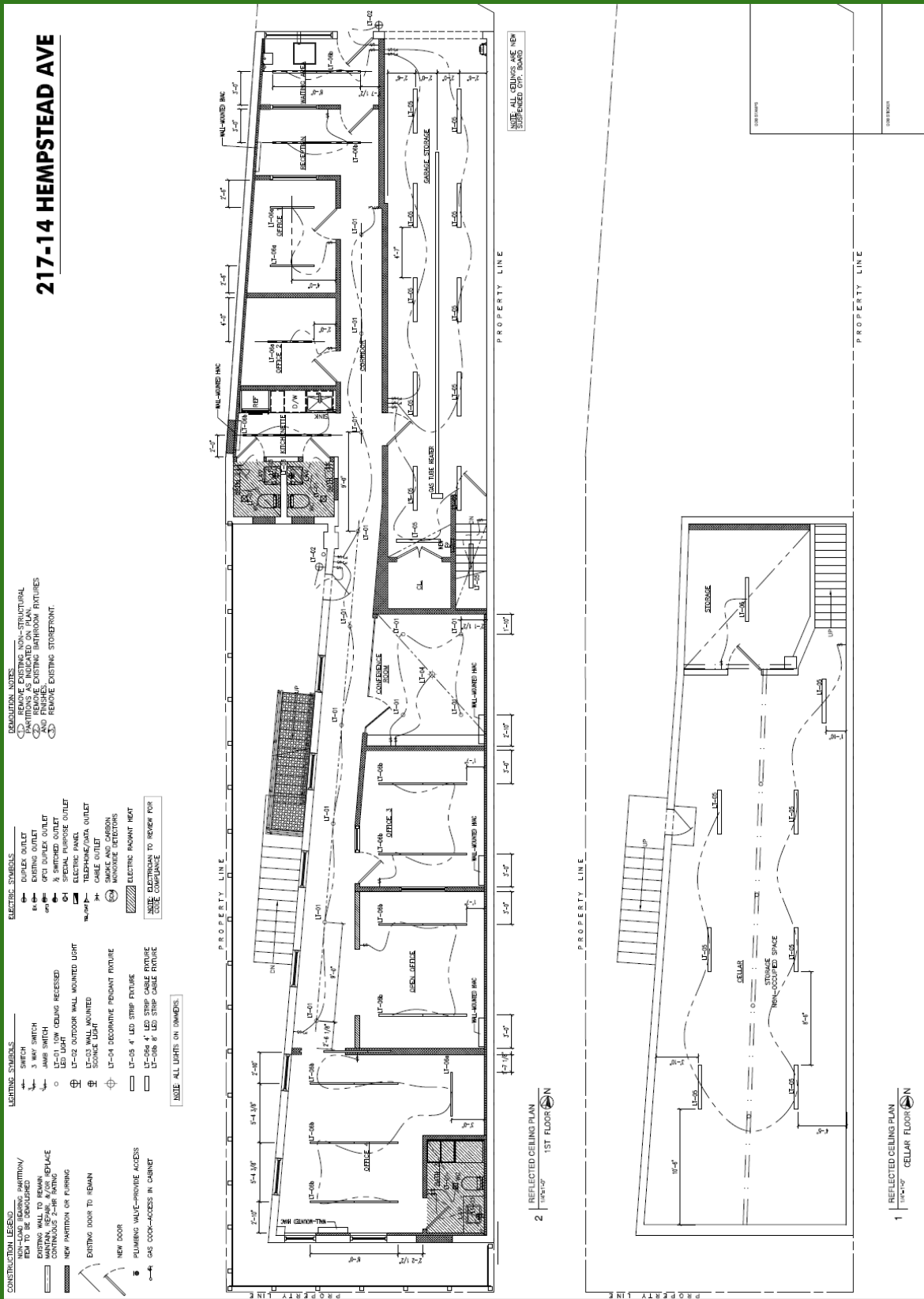

- CONSTRUCTION LEGEND**
- NON-LOAD BEARING PARTITION/ WALL TO BE DEMOLISHED
 - EXISTING PARTITION TO REMAIN
 - WORKING WALL TO BE REPLACED WITH CONTINUOUS 2-1/2" RATING
 - NEW PARTITION OR FURNING
 - EXISTING DOOR TO REMAIN
 - NEW DOOR
 - PLUMBING VAULT-PROVIDE ACCESS
 - GAS COOK-ACCESS IN CABINET
- REFLECTED CEILING PLAN 1ST FLOOR**
- REFLECTED CEILING PLAN CELLAR FLOOR**

- ELECTRIC SYMBOLS**
- 3 WAY SWITCH
 - JAMB SWITCH
 - 12-01 LOW CEILING RECESSED
 - 12-02 OUTDOOR WALL MOUNTED LIGHT
 - 12-03 WALL MOUNTED SMOKE LIGHT
 - 12-04 DECORATIVE PENDANT ROUTINE
 - 12-05 4" LED STRIP FUTURE
 - 12-06 4" LED STRIP CABLE FUTURE
 - 12-08 8" LED STRIP CABLE FUTURE
- ELECTRIC SYMBOLS**
- DOUBLE OUTLET
 - GFI DOUBLE OUTLET
 - SWITCHED OUTLET
 - SPECIAL PURPOSE OUTLET
 - TELEPHONE/DATA OUTLET
 - CABLE OUTLET
 - SMOKE AND CARBON MONOXIDE DETECTORS
 - ELECTRIC PUMP/HEAT
 - NOTE: ELECTRICIAN TO REVIEW FOR CODE COMPLIANCE

- REVISION NOTES**
- REMOVE EXISTING NON-STRUCTURAL PARTITIONS AS INDICATED ON PLAN
 - REMOVE EXISTING SHOWER PARTIERS AND FINISHES
 - REMOVE EXISTING STORMDOOR



201 Moreland Road, Ste 4, Hauppauge, NY 11788
 (631) 770-0700 ~ info@metrorealtyservices.com
 www.metrorealtyservices.com

Exclusive Agent:

Mark Timpone
 Licensed Real Estate Broker
 Managing Partner
 Cell: (516) 375-8069
mark@metrorealtyservices.com

Exclusive Agent:

Jeremy D. Hackett
 Licensed Real Estate Broker
 Managing Partner
 Cell: (516) 456-0108
jeremy@metrorealtyservices.com

All information submitted is subject to errors, omissions, change of price or rental, change of other terms and conditions, prior sale, lease, financing or withdrawal without notice. All areas and dimensions are approximate. This advertisement does not suggest that the broker has a listing on this property or properties or that any property is currently available.