

# For Lease | Industrial Condo 148-1 Remington Blvd, Ronkonkoma NY 11779



Condo Size: 2,378 sf ±  
Offices: 358 sf ±  
Ceiling Height: 16' ±  
Docks: 1  
Heat: Gas  
Power: 200 amps

- Located Just Off Veterans Memorial Highway
- Easy Access To LIE & Sunrise Highway
- Fully Sprinklered
- Two Bathrooms

Lease Price: \$ 16.50 per sf gross

## METRO

REALTY SERVICES LLC

201 Moreland Road, Ste 4, Hauppauge, NY 11788

(631) 770-0700 ~ [info@metrorealtyservices.com](mailto:info@metrorealtyservices.com)

[www.metrorealtyservices.com](http://www.metrorealtyservices.com)

### **Exclusive Agent:**

Jeremy D. Hackett

Licensed Real Estate Broker

Managing Partner

Cell: [\(516\) 456-0108](tel:5164560108)

[jeremy@metrorealtyservices.com](mailto:jeremy@metrorealtyservices.com)

For Lease | Industrial Condo  
148-1 Remington Blvd, Ronkonkoma NY 11779



148-1 Loading

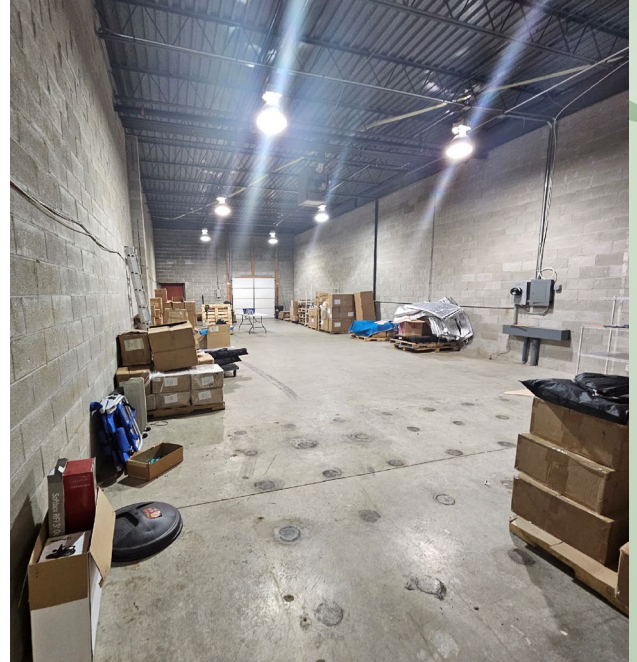

**METRO**

REALTY SERVICES LLC

201 Moreland Road, Ste 4, Hauppauge, NY 11788

(631) 770-0700 ~ [info@metrorealtyservices.com](mailto:info@metrorealtyservices.com)

[www.metrorealtyservices.com](http://www.metrorealtyservices.com)

**Exclusive Agent:**

Jeremy D. Hackett

Licensed Real Estate Broker

Managing Partner

Cell: [\(516\) 456-0108](tel:5164560108)

[jeremy@metrorealtyservices.com](mailto:jeremy@metrorealtyservices.com)

All information submitted is subject to errors, omissions, change of price or rental, change of other terms and conditions, prior sale, lease, financing or withdrawal without notice. All areas and dimensions are approximate. This advertisement does not suggest that the broker has a listing on this property or properties or that any property is currently available.

For Lease | Industrial Condo  
148-1 Remington Blvd, Ronkonkoma NY 11779

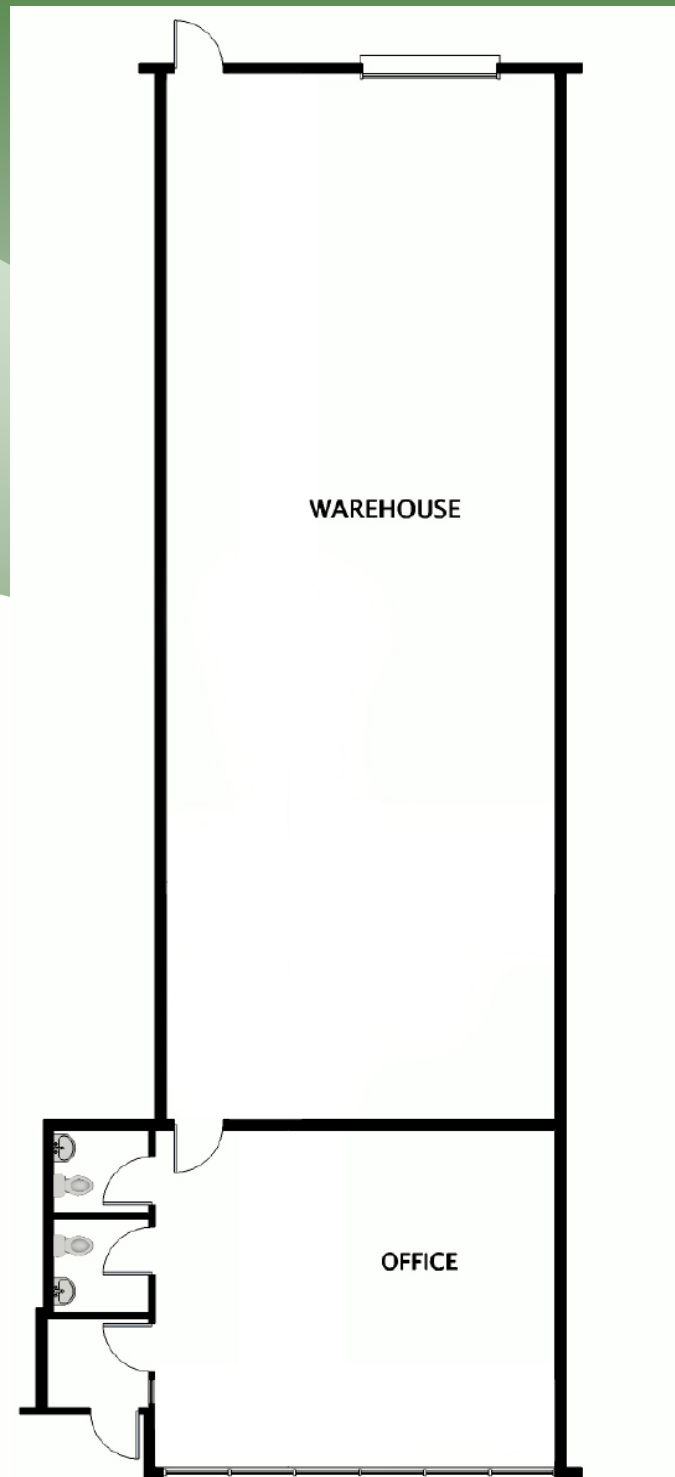

**METRO**

REALTY SERVICES LLC

201 Moreland Road, Ste 4, Hauppauge, NY 11788

(631) 770-0700 ~ [info@metrorealtyservices.com](mailto:info@metrorealtyservices.com)

[www.metrorealtyservices.com](http://www.metrorealtyservices.com)

**Exclusive Agent:**

Jeremy D. Hackett

Licensed Real Estate Broker

Managing Partner

Cell: [\(516\) 456-0108](tel:5164560108)

[jeremy@metrorealtyservices.com](mailto:jeremy@metrorealtyservices.com)

All information submitted is subject to errors, omissions, change of price or rental, change of other terms and conditions, prior sale, lease, financing or withdrawal without notice. All areas and dimensions are approximate. This advertisement does not suggest that the broker has a listing on this property or properties or that any property is currently available.